

Comparable Photo Page

Borrower/Client	Robert & Betty Marshall				
Property Address	30393 Upper Bear Creek				
City	Evergreen	County	Jefferson	State	CO Zip Code 80439
Lender	Bank Of The West				

**Comparable 7**

32834 Upper Bear Creek Road
 Prox. to Subject 1.61 miles W
 Sales Price 795,000
 Gross Living Area 3,218
 Total Rooms 10
 Total Bedrooms 5
 Total Bathrooms 3.0
 Location N;Mountain;
 View B;Wtr;Mtn
 Site 4.77 ac
 Quality Q3
 Age 65

Comparable 8

Prox. to Subject
 Sales Price
 Gross Living Area
 Total Rooms
 Total Bedrooms
 Total Bathrooms
 Location
 View
 Site
 Quality
 Age

Comparable 9

Prox. to Subject
 Sales Price
 Gross Living Area
 Total Rooms
 Total Bedrooms
 Total Bathrooms
 Location
 View
 Site
 Quality
 Age

Building Sketch

Borrower/Client	Robert & Betty Marshall			
Property Address	30393 Upper Bear Creek			
City	Evergreen	County	Jefferson	State CO Zip Code 80439
Lender	Bank Of The West			

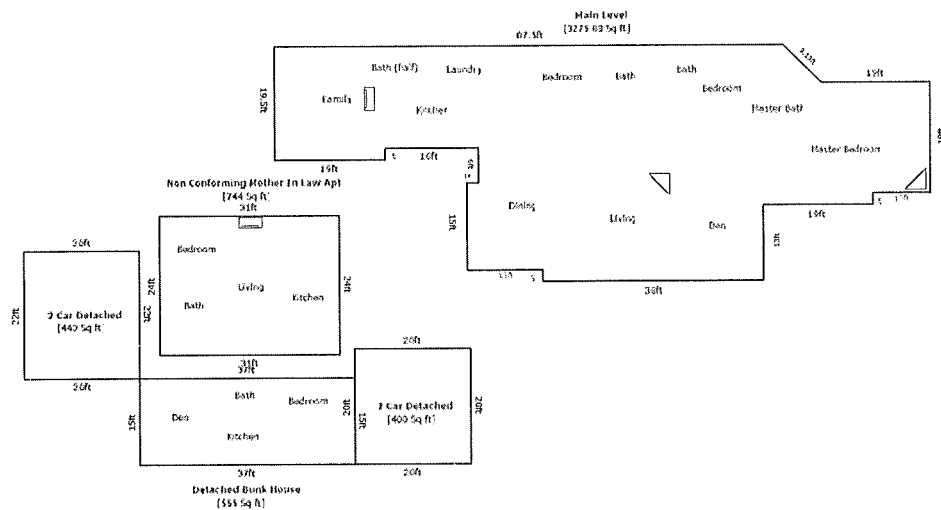

DeVinci by a la mode, Inc

Area Calculations Summary

Living Area		Calculation Details	
Main Level	3275.9 Sq ft	38 x 2	= 76
		51 x 11	= 561
		70 x 2	= 140
		80 x 2	= 160
		78 x 6	= 468
		19 x 2	= 38
		113 x 11	= 1243
		0.5 x 6.5 x 6.5	= 21.125
		87.5 x 6.5	= 568.75
Total Living Area (Rounded):	3276 Sq ft		
Non-living Area			
2 Car Detached	400 Sq ft	20 x 20	= 400
2 Car Detached	440 Sq ft	22 x 20	= 440
Detached Bunk House	555 Sq ft	15 x 37	= 555
Non-Conforming Mother In Law Apt	744 Sq ft	24 x 31	= 744

Location Map

Borrower/Client	Robert & Betty Marshall			
Property Address	30393 Upper Bear Creek			
City	Evergreen	County	Jefferson	State CO Zip Code 80439
Lender	Bank Of The West			

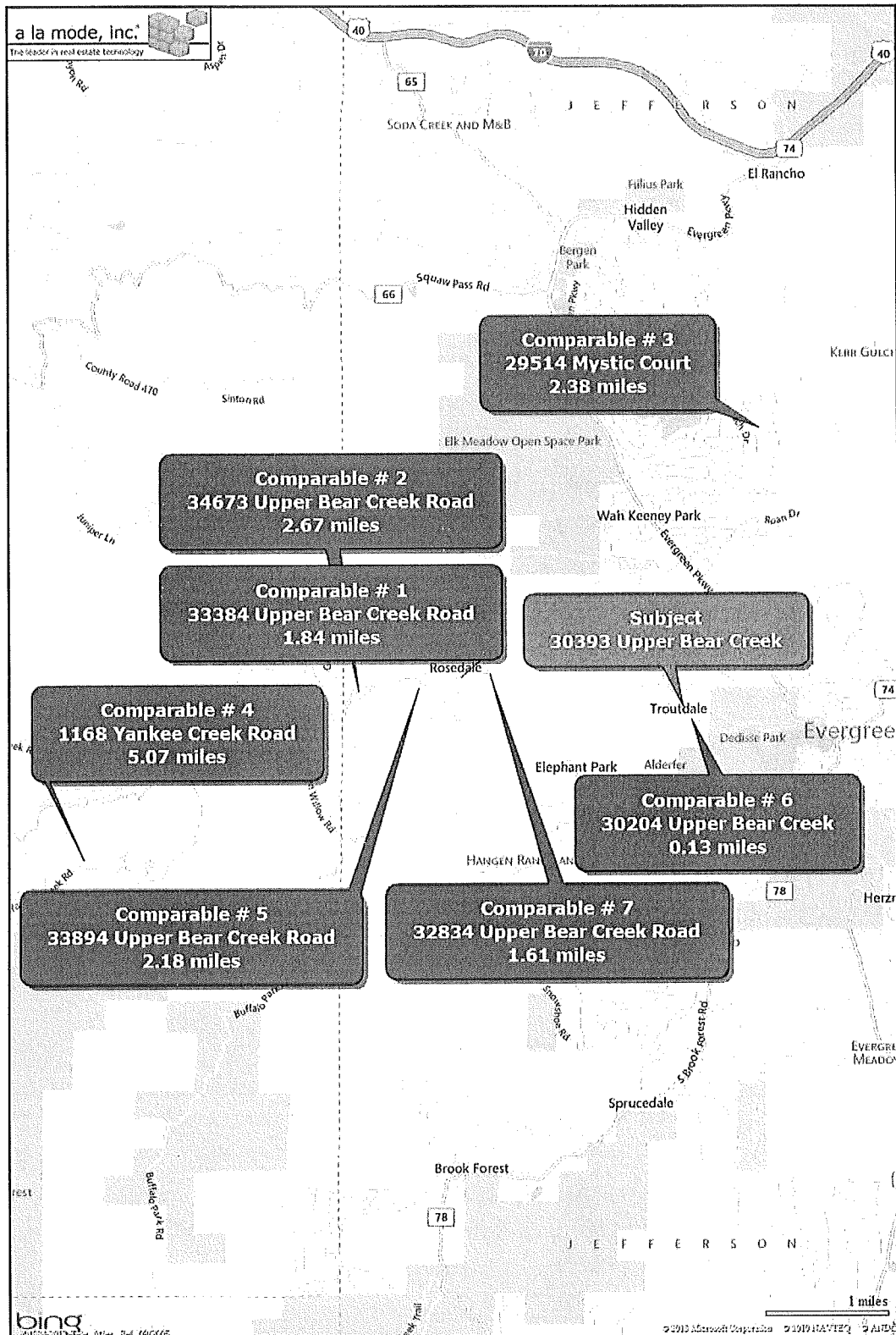

Flood Map

Borrower/Client	Robert & Betty Marshall			
Property Address	30393 Upper Bear Creek			
City	Evergreen	County	Jefferson	State CO Zip Code 80439
Lender	Bank Of The West			

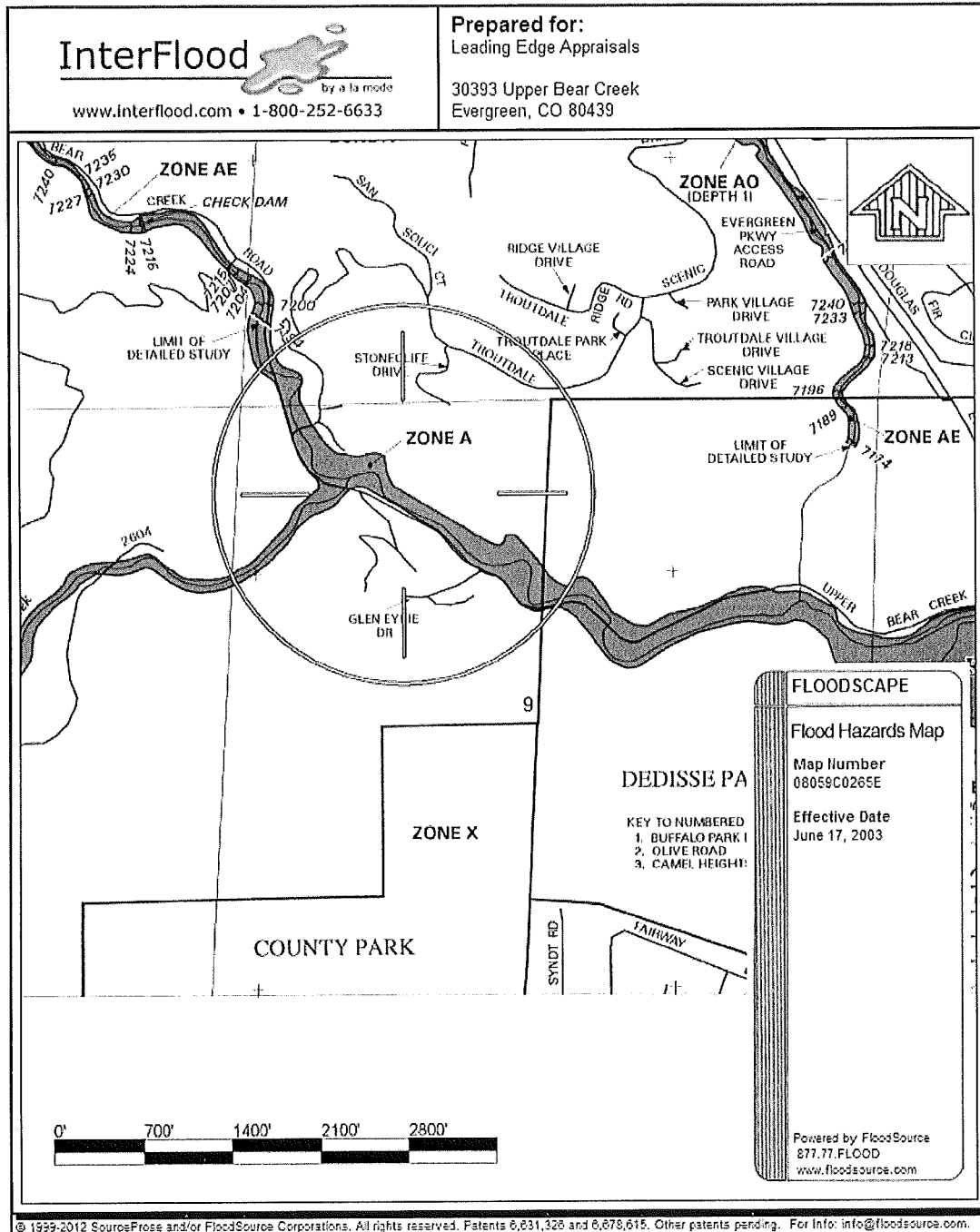

© 1999-2012 SourceProse and/or FloodSource Corporations. All rights reserved. Patents 6,831,326 and 6,878,615. Other patents pending. For Info: info@floodsource.com.

UNIFORM APPRAISAL DATASET (UAD) DEFINITIONS ADDENDUM*(Source: Fannie Mae UAD Appendix D: UAD Field-Specific Standardization Requirements)***Condition Ratings and Definitions****C1**

The improvements have been recently constructed and have not been previously occupied. The entire structure and all components are new and the dwelling features no physical depreciation.

Note: Newly constructed improvements that feature recycled or previously used materials and/or components can be considered new dwellings provided that the dwelling is placed on a 100 percent new foundation and the recycled materials and the recycled components have been rehabilitated/remanufactured into like-new condition. Improvements that have not been previously occupied are not considered "new" if they have any significant physical depreciation (that is, newly constructed dwellings that have been vacant for an extended period of time without adequate maintenance or upkeep).

C2

The improvements feature no deferred maintenance, little or no physical depreciation, and require no repairs. Virtually all building components are new or have been recently repaired, refinished, or rehabilitated. All outdated components and finishes have been updated and/or replaced with components that meet current standards. Dwellings in this category are either almost new or have been recently completely renovated and are similar in condition to new construction.

Note: The improvements represent a relatively new property that is well maintained with no deferred maintenance and little or no physical depreciation, or an older property that has been recently completely renovated.

C3

The improvements are well maintained and feature limited physical depreciation due to normal wear and tear. Some components, but not every major building component, may be updated or recently rehabilitated. The structure has been well maintained.

Note: The improvement is in its first-cycle of replacing short-lived building components (appliances, floor coverings, HVAC, etc.) and is being well maintained. Its estimated effective age is less than its actual age. It also may reflect a property in which the majority of short-lived building components have been replaced but not to the level of a complete renovation.

C4

The improvements feature some minor deferred maintenance and physical deterioration due to normal wear and tear. The dwelling has been adequately maintained and requires only minimal repairs to building components/mechanical systems and cosmetic repairs. All major building components have been adequately maintained and are functionally adequate.

Note: The estimated effective age may be close to or equal to its actual age. It reflects a property in which some of the short-lived building components have been replaced, and some short-lived building components are at or near the end of their physical life expectancy; however, they still function adequately. Most minor repairs have been addressed on an ongoing basis resulting in an adequately maintained property.

C5

The improvements feature obvious deferred maintenance and are in need of some significant repairs. Some building components need repairs, rehabilitation, or updating. The functional utility and overall livability is somewhat diminished due to condition, but the dwelling remains useable and functional as a residence.

Note: Some significant repairs are needed to the improvements due to the lack of adequate maintenance. It reflects a property in which many of its short-lived building components are at the end of or have exceeded their physical life expectancy but remain functional.

C6

The improvements have substantial damage or deferred maintenance with deficiencies or defects that are severe enough to affect the safety, soundness, or structural integrity of the improvements. The improvements are in need of substantial repairs and rehabilitation, including many or most major components.

Note: Substantial repairs are needed to the improvements due to the lack of adequate maintenance or property damage. It reflects a property with conditions severe enough to affect the safety, soundness, or structural integrity of the improvements.

Quality Ratings and Definitions**Q1**

Dwellings with this quality rating are usually unique structures that are individually designed by an architect for a specified user. Such residences typically are constructed from detailed architectural plans and specifications and feature an exceptionally high level of workmanship and exceptionally high-grade materials throughout the interior and exterior of the structure. The design features exceptionally high-quality exterior refinements and ornamentation, and exceptionally high-quality interior refinements. The workmanship, materials, and finishes throughout the dwelling are of exceptionally high quality.

Q2

Dwellings with this quality rating are often custom designed for construction on an individual property owner's site. However, dwellings in this quality grade are also found in high-quality tract developments featuring residence constructed from individual plans or from highly modified or upgraded plans. The design features detailed, high quality exterior ornamentation, high-quality interior refinements, and detail. The workmanship, materials, and finishes throughout the dwelling are generally of high or very high quality.

UNIFORM APPRAISAL DATASET (UAD) DEFINITIONS ADDENDUM

(Source: Fannie Mae UAD Appendix D: UAD Field-Specific Standardization Requirements)

Quality Ratings and Definitions (continued)

Q3

Dwellings with this quality rating are residences of higher quality built from individual or readily available designer plans in above-standard residential tract developments or on an individual property owner's site. The design includes significant exterior ornamentation and interiors that are well finished. The workmanship exceeds acceptable standards and many materials and finishes throughout the dwelling have been upgraded from "stock" standards.

Q4

Dwellings with this quality rating meet or exceed the requirements of applicable building codes. Standard or modified standard building plans are utilized and the design includes adequate fenestration and some exterior ornamentation and interior refinements. Materials, workmanship, finish, and equipment are of stock or builder grade and may feature some upgrades.

Q5

Dwellings with this quality rating feature economy of construction and basic functionality as main considerations. Such dwellings feature a plain design using readily available or basic floor plans featuring minimal fenestration and basic finishes with minimal exterior ornamentation and limited interior detail. These dwellings meet minimum building codes and are constructed with inexpensive, stock materials with limited refinements and upgrades.

Q6

Dwellings with this quality rating are of basic quality and lower cost; some may not be suitable for year-round occupancy. Such dwellings are often built with simple plans or without plans, often utilizing the lowest quality building materials. Such dwellings are often built or expanded by persons who are professionally unskilled or possess only minimal construction skills. Electrical, plumbing, and other mechanical systems and equipment may be minimal or non-existent. Older dwellings may feature one or more substandard or non-conforming additions to the original structure.

Definitions of Not Updated, Updated, and Remodeled

Not Updated

Little or no updating or modernization. This description includes, but is not limited to, new homes.

Residential properties of fifteen years of age or less often reflect an original condition with no updating, if no major components have been replaced or updated. Those over fifteen years of age are also considered not updated if the appliances, fixtures, and finishes are predominantly dated. An area that is 'Not Updated' may still be well maintained and fully functional, and this rating does not necessarily imply deferred maintenance or physical/functional deterioration.

Updated

The area of the home has been modified to meet current market expectations. These modifications are limited in terms of both scope and cost.

An updated area of the home should have an improved look and feel, or functional utility. Changes that constitute updates include refurbishment and/or replacing components to meet existing market expectations. Updates do not include significant alterations to the existing structure.

Remodeled

Significant finish and/or structural changes have been made that increase utility and appeal through complete replacement and/or expansion.

A remodeled area reflects fundamental changes that include multiple alterations. These alterations may include some or all of the following: replacement of a major component (cabinet(s), bathtub, or bathroom tile), relocation of plumbing/gas fixtures/appliances, significant structural alterations (relocating walls, and/or the addition of square footage). This would include a complete gutting and rebuild.

Explanation of Bathroom Count

Three-quarter baths are counted as a full bath in all cases. Quarter baths (baths that feature only a toilet) are not included in the bathroom count. The number of full and half baths is reported by separating the two values using a period, where the full bath count is represented to the left of the period and the half bath count is represented to the right of the period.

Example:

3.2 indicates three full baths and two half baths.

UNIFORM APPRAISAL DATASET (UAD) DEFINITIONS ADDENDUM

(Source: Fannie Mae UAD Appendix D: UAD Field-Specific Standardization Requirements)

Abbreviations Used In Data Standardization Text

Abbreviation	Full Name	Fields Where This Abbreviation May Appear
ac	Acres	Area, Site
AdjPrk	Adjacent to Park	Location
AdjPwr	Adjacent to Power Lines	Location
A	Adverse	Location & View
ArmlLth	Arms Length Sale	Sale or Financing Concessions
ba	Bathroom(s)	Basement & Finished Rooms Below Grade
br	Bedroom	Basement & Finished Rooms Below Grade
B	Beneficial	Location & View
Cash	Cash	Sale or Financing Concessions
CtySky	City View Skyline View	View
CtyStr	City Street View	View
Comm	Commercial Influence	Location
c	Contracted Date	Date of Sale/Time
Conv	Conventional	Sale or Financing Concessions
CrtOrd	Court Ordered Sale	Sale or Financing Concessions
DOM	Days On Market	Data Sources
e	Expiration Date	Date of Sale/Time
Estate	Estate Sale	Sale or Financing Concessions
FHA	Federal Housing Authority	Sale or Financing Concessions
GlfCse	Golf Course	Location
Glfvw	Golf Course View	View
Ind	Industrial	Location & View
in	Interior Only Stairs	Basement & Finished Rooms Below Grade
Lndfl	Landfill	Location
LtdSght	Limited Sight	View
Listing	Listing	Sale or Financing Concessions
Mtn	Mountain View	View
N	Neutral	Location & View
NonArm	Non-Arms Length Sale	Sale or Financing Concessions
BsyRd	Busy Road	Location
o	Other	Basement & Finished Rooms Below Grade
Prk	Park View	View
Pstrl	Pastoral View	View
PwrLn	Power Lines	View
PubTrn	Public Transportation	Location
rr	Recreational (Rec) Room	Basement & Finished Rooms Below Grade
Relo	Relocation Sale	Sale or Financing Concessions
REO	REO Sale	Sale or Financing Concessions
Res	Residential	Location & View
RH	USDA - Rural Housing	Sale or Financing Concessions
s	Settlement Date	Date of Sale/Time
Short	Short Sale	Sale or Financing Concessions
sf	Square Feet	Area, Site, Basement
sqm	Square Meters	Area, Site
Unk	Unknown	Date of Sale/Time
VA	Veterans Administration	Sale or Financing Concessions
w	Withdrawn Date	Date of Sale/Time
wo	Walk Out Basement	Basement & Finished Rooms Below Grade
wu	Walk Up Basement	Basement & Finished Rooms Below Grade
WtrFr	Water Frontage	Location
Wtr	Water View	View
Woods	Woods View	View

Other Appraiser-Defined Abbreviations

[illegible]

E & O Insurance

Borrower/Client	Robert & Betty Marshall				
Property Address	30393 Upper Bear Creek				
City	Evergreen	County	Jefferson	State	CO Zip Code 80439
Lender	Bank Of The West				

NAVIGATORS INSURANCE COMPANY

THIS IS BOTH A CLAIMS MADE AND REPORTED INSURANCE POLICY.

THIS POLICY APPLIES TO THOSE CLAIMS THAT ARE FIRST MADE AGAINST THE INSURED AND REPORTED IN WRITING TO THE COMPANY DURING THE POLICY PERIOD.

PLEASE READ THIS POLICY CAREFULLY.

**REAL ESTATE APPRAISERS ERRORS AND OMISSIONS INSURANCE POLICY
DECLARATIONS**POLICY NUMBER: PH12RAL129388IV RENEWAL OF: _____

1. NAMED INSURED: Troy Nozinger
2. ADDRESS: 30573 L. Sun Creek Drive
Evergreen, CO 80439
3. POLICY PERIOD: FROM: 07/20/2012 TO: 07/20/2013
12:01 A.M. Standard Time at the address of the Named Insured as stated in Number 2 above.
4. LIMITS OF LIABILITY:
 - A. \$ 500,000 Damages Limit of Liability - Each Claim
 - B. \$ 500,000 Claim Expenses Limit of Liability - Each Claim
 - C. \$ 1,000,000 Damages Limit of Liability - Policy Aggregate
 - D. \$ 1,000,000 Claim Expenses Limit of Liability - Policy Aggregate
5. DEDUCTIBLE (Inclusive of claim expenses):
 - A. \$ 500 Each Claim
 - B. \$ 1,000 Aggregate
6. PREMIUM: \$ 617.00
7. RETROACTIVE DATE: 07/20/2012
8. FORMS ATTACHED: NAV RAL NIC PF (02/11) NAV RAL 300 CO (02/11)
NAV RAL 002 (02/11)

PROGRAM ADMINISTRATOR: Herbert H. Lundy Insurance Agency Inc.
75 Second Ave Suite 410 Needham, MA 02464-2876

By Acceptance of this policy the Insured agrees that the statements in the Declarations and the Application and any attachments hereto are the Insured's agreements and representations and that this policy embodies all agreements existing between the Insured and the Company or any of its representatives relating to this insurance.

IN WITNESS WHEREOF, we have caused this policy to be signed by our President and Secretary.



[Emily Miner]
Secretary

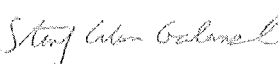

[Stanley A. Galenski]
President

NAV RAL DEC (02/11)

Page 1 of 1

NAVIGATORS
Insuring A World to Measure

Appraisers License

Borrower/Client	Robert & Betty Marshall				
Property Address	30393 Upper Bear Creek				
City	Evergreen	County	Jefferson	State	CO Zip Code 80439
Lender	Bank Of The West				

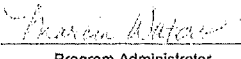
STATE OF COLORADO		
Department of Regulatory Agencies		
Division of Real Estate		
Active Licensed Appraiser	PRINTED ON SECURE PAPER	
40031063	Jan 1 2012	Dec 31 2014
Number	Issue Date	Expires
TROY E NOFZINGER EVERGREEN, CO 80439		
 Program Administrator		_____ Licensee Signature