

According to marks.

LPGAS LINE PATH AS PER MR O'NEIL.

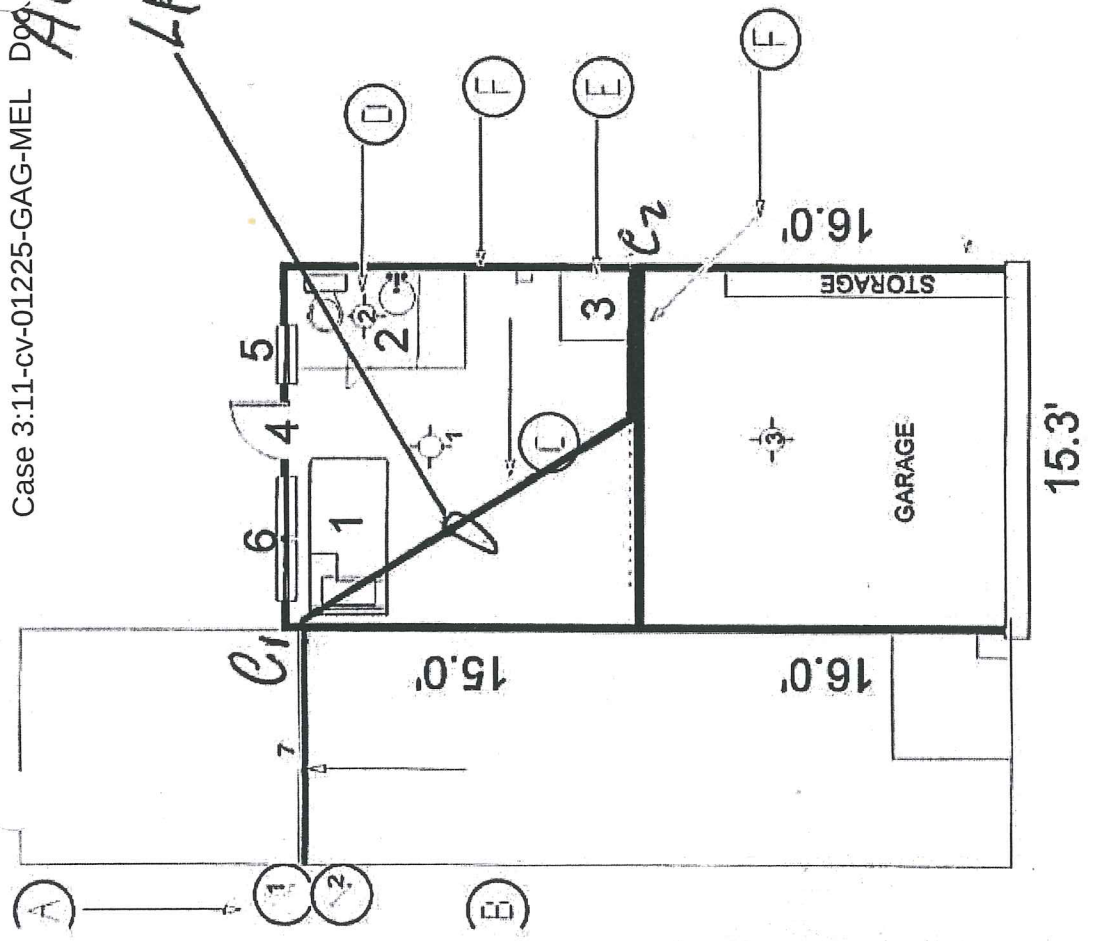

JOINT EXHIBIT
 CIV. 11-1225 (GAG)

[Handwritten signature]

EXCAVATION WILL BE MADE FROM C1 - C2

IN ORDER TO DETERMINE IF THERE EXIST ANY PHYSICAL EVIDENCE OF GAS PIPING WHICH WAS IN PLACE DURING DATE OF FIRE WITHIN THIS SPACE